

# LP 5.00 Series

# Printed Circuit Board Terminals / 5.00 mm Pitch

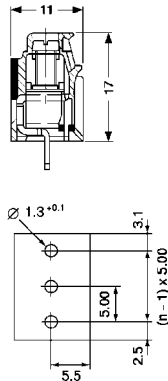

**LP 5.00/90**



Technical data	VDE	UL	CSA
<b>Rated voltage (V)</b>	250*	300	300
<b>Rated current (A)</b>	25	15	20
<b>Wire size (mm<sup>2</sup>/AWG)</b>	4.0	26...12	26...12

\*Pollution severity 3 / Overvoltage category III

Additional technical data see page 58

**Solder pin length**      4.5 mm      4.5 mm

Color				
Poles	Type	Part No.	Part No.	Qty.
2	LP 5.00/2/90	1594500000	1696060000	100
3	LP 5.00/3/90	1594510000	1696070000	100
4	LP 5.00/4/90	995002	995023	
5	LP 5.00/5/90	995003	995024	
6	LP 5.00/6/90	995004	995025	
7	LP 5.00/7/90	995005	995026	
8	LP 5.00/8/90	995006	995027	
9	LP 5.00/9/90	995007	995028	
10	LP 5.00/10/90	995008	995029	
11	LP 5.00/11/90	995009	995030	
12	LP 5.00/12/90	995010	995031	
13	LP 5.00/13/90	995011	995032	
14	LP 5.00/14/90	995012	995033	
15	LP 5.00/15/90	995013	995034	
16	LP 5.00/16/90	995014	995035	
17	LP 5.00/17/90	995015	995036	
18	LP 5.00/18/90	995016	995037	
19	LP 5.00/19/90	995017	995038	
20	LP 5.00/20/90	995018	995039	
21	LP 5.00/21/90	995019	995040	
22	LP 5.00/22/90	995020	995041	
23	LP 5.00/23/90	995021	995042	
24	LP 5.00/24/90	995022	995043	

Accessories	Page
Marking	40
Mounting	46
Miscellaneous	46

**LPP 5.00/90**



with test point

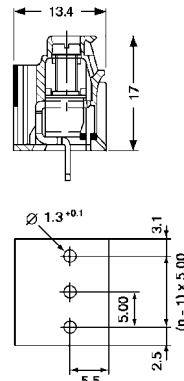

Technical data	VDE	UL	CSA
<b>Rated voltage (V)</b>	250*	300	300
<b>Rated current (A)</b>	25	15	20
<b>Wire size (mm<sup>2</sup>/AWG)</b>	4.0	26...12	26...12

\*Pollution severity 3 / Overvoltage category III

Additional technical data see page 58

**Solder pin length**      4.5 mm      4.5 mm

Color				
Poles	Type	Part No.	Part No.	Qty.
2	LPP 5.00/2/90	1594520000	1697140000	100
3	LPP 5.00/3/90	1594530000	1697150000	100
4	LPP 5.00/4/90	995044	995065	
5	LPP 5.00/5/90	995045	995066	
6	LPP 5.00/6/90	995046	995067	
7	LPP 5.00/7/90	995047	995068	
8	LPP 5.00/8/90	995048	995069	
9	LPP 5.00/9/90	995049	995070	
10	LPP 5.00/10/90	995050	995071	
11	LPP 5.00/11/90	995051	995072	
12	LPP 5.00/12/90	995052	995073	
13	LPP 5.00/13/90	995053	995074	
14	LPP 5.00/14/90	995054	995075	
15	LPP 5.00/15/90	995055	995076	
16	LPP 5.00/16/90	995056	995077	
17	LPP 5.00/17/90	995057	995078	
18	LPP 5.00/18/90	995058	995079	
19	LPP 5.00/19/90	995059	995080	
20	LPP 5.00/20/90	995060	995081	
21	LPP 5.00/21/90	995061	995082	
22	LPP 5.00/22/90	995062	995083	
23	LPP 5.00/23/90	995063	995084	
24	LPP 5.00/24/90	995064	995085	

Accessories	Page
Marking	40
Mounting	46
Miscellaneous	43

**LP 5.00/135**



with test point

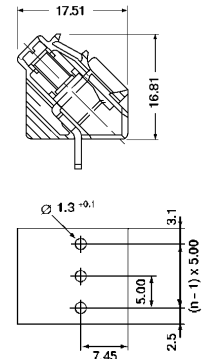

Technical data	VDE	UL	CSA
<b>Rated voltage (V)</b>	250*	300	300
<b>Rated current (A)</b>	25	15	20
<b>Wire size (mm<sup>2</sup>/AWG)</b>	4.0	26...12	26...12

\*Pollution severity 3 / Overvoltage category III

Additional technical data see page 58

**Solder pin length**      4.5 mm      4.5 mm

Color				
Poles	Type	Part No.	Part No.	Qty.
2	LP 5.00/2/135	1595760000	1697180000	100
3	LP 5.00/3/135	1595720000	1697190000	100
4	LP 5.00/4/135	995086	995107	
5	LP 5.00/5/135	995087	995108	
6	LP 5.00/6/135	995088	995109	
7	LP 5.00/7/135	995089	995110	
8	LP 5.00/8/135	995090	995111	
9	LP 5.00/9/135	995091	995112	
10	LP 5.00/10/135	995092	995113	
11	LP 5.00/11/135	995093	995114	
12	LP 5.00/12/135	995094	995115	
13	LP 5.00/13/135	995095	995116	
14	LP 5.00/14/135	995096	995117	
15	LP 5.00/15/135	995097	995118	
16	LP 5.00/16/135	995098	995119	
17	LP 5.00/17/135	995099	995120	
18	LP 5.00/18/135	995100	995121	
19	LP 5.00/19/135	995101	995122	
20	LP 5.00/20/135	995102	995123	
21	LP 5.00/21/135	995103	995124	
22	LP 5.00/22/135	995104	995125	
23	LP 5.00/23/135	995105	995126	
24	LP 5.00/24/135	995106	995127	

Accessories	Page
Marking	40
Mounting	-
Miscellaneous	46