

Rectangular Connectors MC Series

14 MODULE FRAME

1

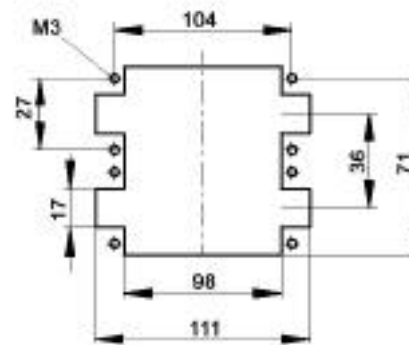
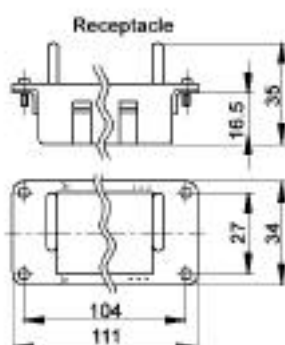
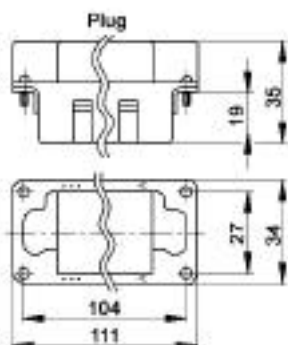
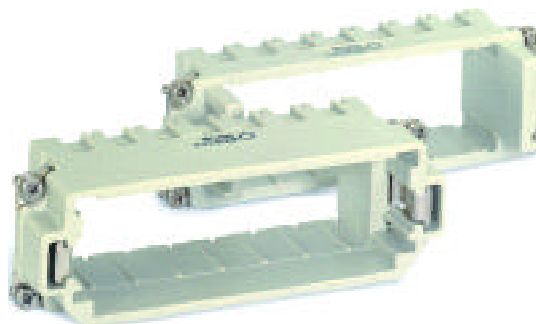
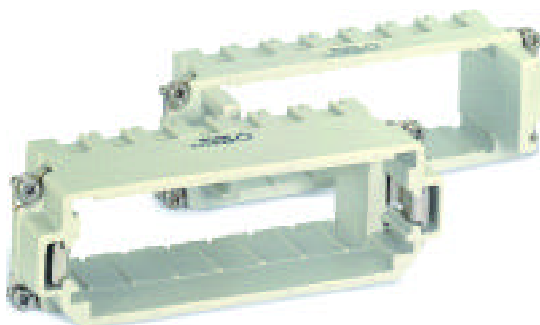

All dimensions are in mm.

By using two sets of 7 module frames, 14 modules can be accommodated.

Plug	Receptacle
10.3816 (2X)	10.3817 (2X)

These frames fit in the HBE 48 Series Housings which are on the following pages.

MODULE REMOVAL TOOL



Removal Tool:
11.1712

Rectangular Connectors MC Series

HBE 48 HOODS WITH SINGLE LEVER BOLTS

TOP ENTRY

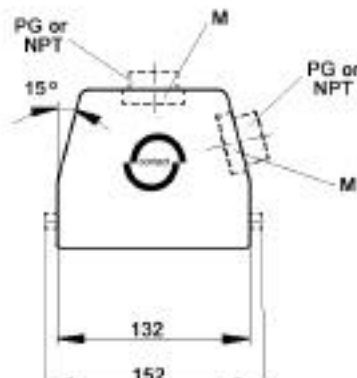
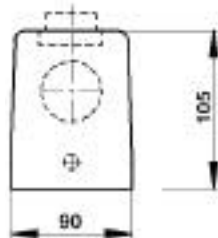

SIDE ENTRY

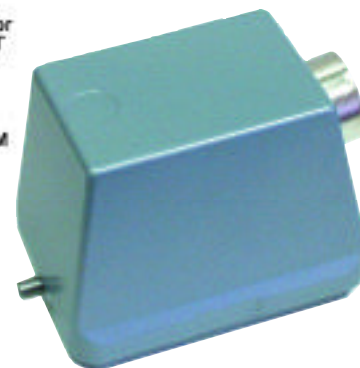

Position of Cable Entry	Size of Entry			Standard Grey Coating			Strain Relief		
	PG	NPT	Metric	PG Part #	NPT Part #	Metric Part #	PG	NPT	M
Top Entry	29	1"	32	10.1550	10.1550NP	19.1550	●	■	▲
	36	1 1/4"	40	10.1560	10.1560NP	19.1560	●	■	▲
	42	-	50	10.1570	-	19.1570	●	■	▲
Side Entry	29	1"	32	10.1580	10.1580NP	19.1580	●	■	▲
	36	1 1/4"	40	10.1590	10.1590NP	19.1590	●	■	▲
	42	-	50	10.1600	-	19.1600	●	■	▲

All dimensions are in mm.

Metric hoods do not come with a neck.

HBE 48 PANEL MOUNT BASES WITH SINGLE LEVER

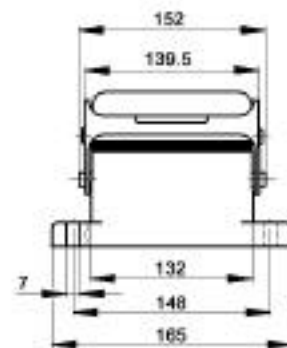
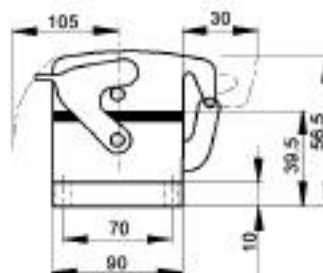

All dimensions are in mm.

Without Dust Cover	With Dust Cover with hold down screws and no dust cover bolts	With Dust Cover with hold down screws and dust cover bolts
10.1610	10.1520	10.1525

www.contactelectronics.com
800-221-1451

Rectangular Connectors MC Series

HBE 48 SURFACE MOUNT BASES WITH LEVERS

1

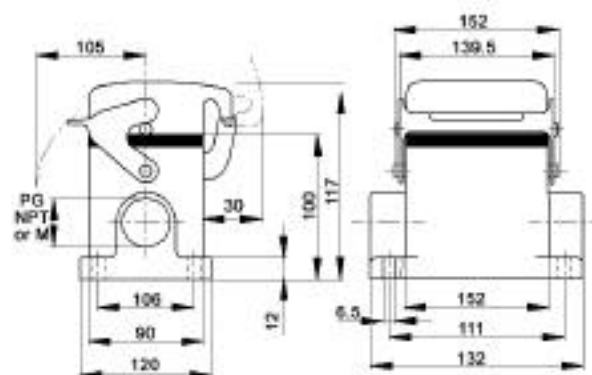
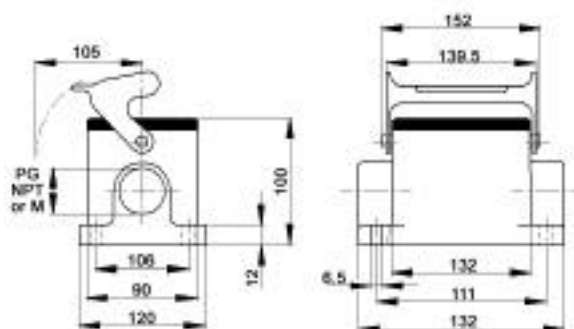
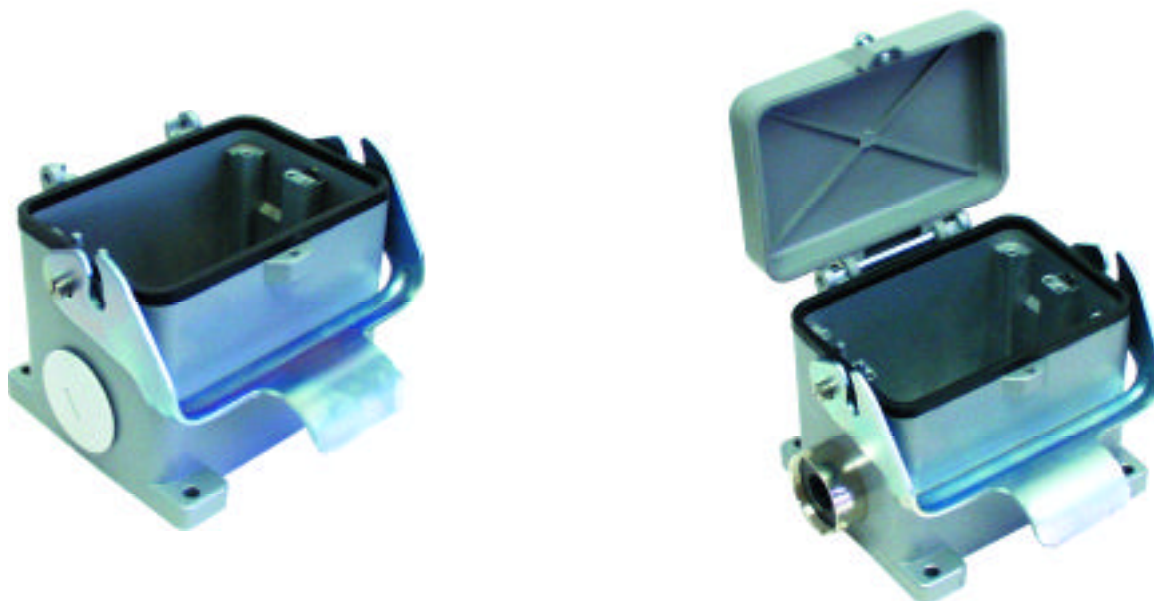

All dimensions are in mm.

Position of Cable Entry	Size of Entry			Standard Grey Coating			Strain Relief		
	PG	NPT	Metric	PG Part #	NPT Part #	Metric Part #	PG	NPT	M
2 Entries	29	1"	32	10.1660	10.1660NP	19.1660	●	■	▲
	36	1 1/4"	40	10.1661	10.1661NP	19.1661	●	■	▲
1 Entry	29	1"	32	10.1650	10.1650NP	19.1650	●	■	▲
	36	1 1/4"	40	10.1651	10.1651NP	19.1651	●	■	▲
2 Entries with dust cover	29	1"	32	10.1680	10.1680NP	19.1680	●	■	▲
	36	1 1/4"	40	10.1681	10.1681NP	19.1681	●	■	▲
1 Entry with dust cover	29	1"	32	10.1670	10.1670NP	19.1670	●	■	▲
	36	1 1/4"	40	10.1671	10.1671NP	19.1671	●	■	▲

www.contactelectronics.com
800-221-1451