

Rectangular Connectors HDD Series

HDD 72 CRIMP TERMINATED: MACHINE CONTACT INSERTS

1

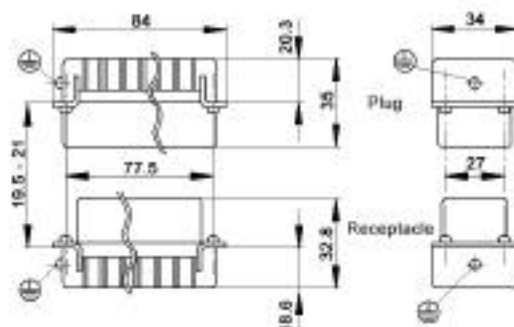

View from Cable Side

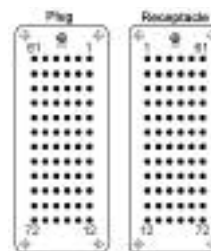

Panel Cut-Out

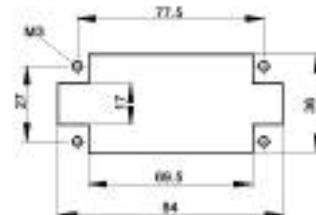

All dimensions are in mm.

These inserts fit in the HBE
16 Series Housings which
are on the following pages.

| Plug | Receptacle |
|---------|------------|
| 11.2852 | 11.2862 |

Contacts Sold Separately

HDD MACHINED CONTACTS: DIAMETER 1.6 MM



| Bags of 100 | | | | | | | |
|-------------|---------|---------|---------|------------------|---------|---------|------------------|
| mm2 | AWG | Silver | | | Gold | | |
| | | Pin | Socket | Stripping Length | Pin | Socket | Stripping Length |
| 0.14 - 0.37 | 26 - 22 | 13.1620 | 13.1630 | 8 | 13.1625 | 13.1635 | 8 |
| 0.5 | 20 | 13.1621 | 13.1631 | 8 | 13.1626 | 13.1636 | 8 |
| 0.75 - 1.0 | 18 | 13.1622 | 13.1632 | 8 | 13.1627 | 13.1637 | 8 |
| 1.5 | 16 | 13.1623 | 13.1633 | 8 | 13.1628 | 13.1638 | 8 |
| 2.5 | 14 | 13.1624 | 13.1634 | 5.8 | - | - | - |

TOOLS



Locator
11.1472



Crimp Dies
11.1471



Crimp Tool
11.1470



Removal Tool:
11.1610

www.contactelectronics.com
800-221-1451

Rectangular Connectors HDD Series

HBE 16 HOODS WITH SINGLE LEVER BOLTS

TOP ENTRY

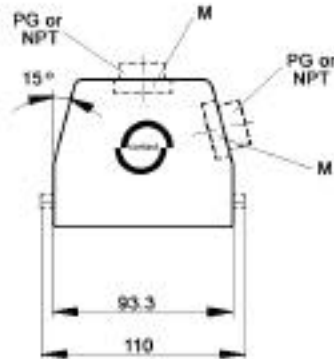

SIDE ENTRY



All dimensions are in mm.

| Position of Cable Entry | Size of Entry | | | Standard Grey Coating | | | Black Coating (NEMA 4X) | | | Strain Relief |
|-------------------------|---------------|------|--------|-----------------------|------------|---------------|-------------------------|------------|---------------|---------------|
| | PG | NPT | Metric | PG Part # | NPT Part # | Metric Part # | PG Part # | NPT Part # | Metric Part # | |
| Top Entry | 21 | 3/4" | 25 | 10.0809 | 10.0809NP | 19.0809 | 70.0990 | 70.0990NP | 79.0990 | PG NPT M |
| | 29 | 1" | 32 | 10.0909 | 10.0909NP | 19.0909 | - | - | - | PG NPT M |
| Side Entry | 21 | 3/4" | 25 | 10.0829 | 10.0829NP | 19.0829 | 70.1090 | 70.1090NP | 79.1090 | PG NPT M |
| | 29 | 1" | 32 | 10.0929 | 10.0929NP | 19.0929 | - | - | - | PG NPT M |

Metric hoods do not come with a neck.

HBE 16 HIGH PROFILE HOODS WITH SINGLE LEVER BOLTS

TOP ENTRY

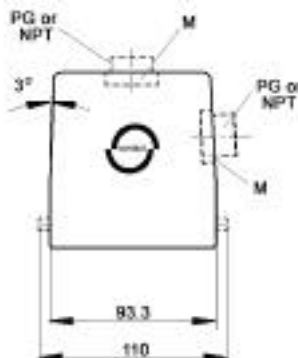

SIDE ENTRY



All dimensions are in mm.

| Position of Cable Entry | Size of Entry | | | Standard Grey Coating | | | Black Coating (NEMA 4X) | | | Strain Relief |
|-------------------------|---------------|------|--------|-----------------------|------------|---------------|-------------------------|------------|---------------|---------------|
| | PG | NPT | Metric | PG Part # | NPT Part # | Metric Part # | PG Part # | NPT Part # | Metric Part # | |
| Top Entry | 21 | 3/4" | 25 | 70.0942 | 70.0942NP | 79.0942 | 70.0992 | 70.0992NP | 79.0992 | PG NPT M |
| | 29 | 1" | 32 | 70.0944 | 70.0944NP | 79.0944 | 70.0994 | 70.0994NP | 79.0994 | PG NPT M |
| Side Entry | 21 | 3/4" | 25 | 70.1042 | 70.1042NP | 79.1042 | 70.1092 | 70.1092NP | 79.1092 | PG NPT M |
| | 29 | 1" | 32 | 70.1044 | 70.1044NP | 79.1044 | 70.1094 | 70.1094NP | 79.1094 | PG NPT M |

Metric hoods do not come with a neck.

www.contactelectronics.com
800-221-1451

Rectangular Connectors HDD Series

HBE 16 PANEL MOUNT BASES WITH SINGLE LEVER

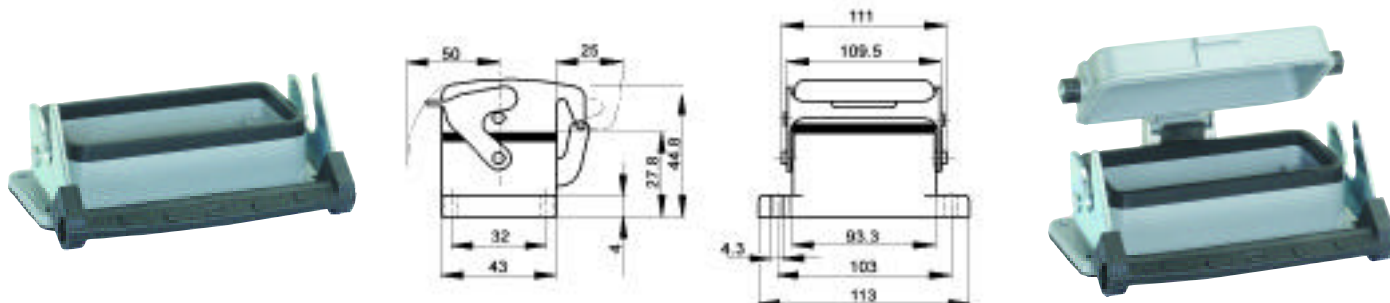

All dimensions are in mm.

| Description | Standard Grey Coating | Black Coating (NEMA 4X) |
|--------------------------------|-----------------------|-------------------------|
| Panel mount without dust cover | 10.0729 | 70.0827 |
| Panel mount with dust cover | 10.0739 | 70.0837 |

HBE 16 SURFACE MOUNT BASES WITH SINGLE LEVER

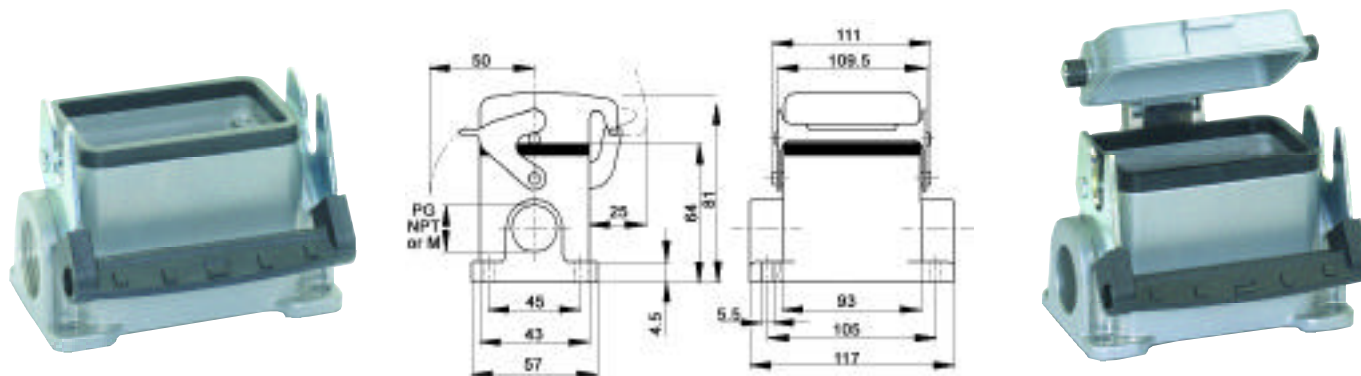

All dimensions are in mm.

| # of Entries | Size of Entry | | | Standard Grey Coating | | | Black Coating (NEMA 4X) | | | Strain Relief |
|---------------------------|---------------|------|--------|-----------------------|------------|---------------|-------------------------|------------|---------------|---------------|
| | PG | NPT | Metric | PG Part # | NPT Part # | Metric Part # | PG Part # | NPT Part # | Metric Part # | |
| 2 Entries | 21 | 3/4" | 25 | 10.0759 | 10.0759NP | 19.0759 | 70.1130 | 70.1130NP | 79.1130 | PG NPT M |
| 1 Entry | 21 | 3/4" | 25 | 10.0749 | 10.0749NP | 19.0749 | 70.1120 | 70.1120NP | 79.1120 | PG NPT M |
| 2 Entries with dust cover | 21 | 3/4" | 25 | 10.0789 | 10.0789NP | 19.0789 | 70.1170 | 70.1170NP | 79.1170 | PG NPT M |
| 1 Entry with dust cover | 21 | 3/4" | 25 | 10.0769 | 10.0769NP | 19.0769 | 70.1160 | 70.1160NP | 79.1160 | PG NPT M |

www.contactelectronics.com
800-221-1451

Rectangular Connectors HDD Series

HBE 16 HIGH PROFILE SURFACE MOUNT BASES WITH SINGLE LEVER

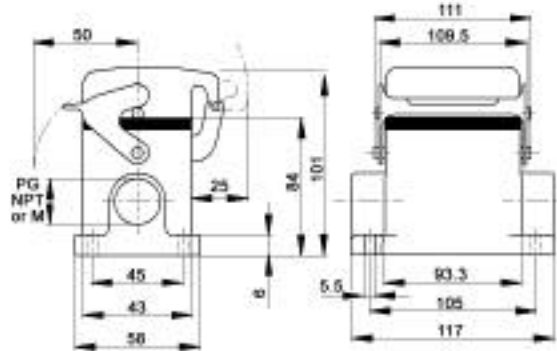
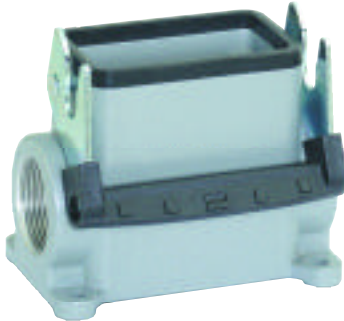

All dimensions are in mm.

| # of Entries | Size of Entry | | | Standard Grey Coating | | | Black Coating (NEMA 4X) | | | Strain Relief | | |
|---------------------------|---------------|------|--------|-----------------------|------------|---------------|-------------------------|------------|---------------|---------------|-----|---|
| | PG | NPT | Metric | PG Part # | NPT Part # | Metric Part # | PG Part # | NPT Part # | Metric Part # | PG | NPT | M |
| 2 Entries | 21 | 3/4" | 25 | 70.1112 | 70.1112NP | 79.1112 | 70.1132 | 70.1132NP | 79.1132 | ● | ■ | ▲ |
| | 29 | 1" | 32 | 70.1114 | 70.1114NP | 79.1114 | 70.1134 | 70.1134NP | 79.1134 | ● | ■ | ▲ |
| 1 Entry | 21 | 3/4" | 25 | 70.1102 | 70.1102NP | 79.1102 | 70.1122 | 70.1122NP | 79.1122 | ● | ■ | ▲ |
| | 29 | 1" | 32 | 70.1104 | 70.1104NP | 79.1104 | 70.1124 | 70.1124NP | 79.1124 | ● | ■ | ▲ |
| 2 Entries with dust cover | 21 | 3/4" | 25 | 70.1152 | 70.1152NP | 79.1152 | 70.1172 | 70.1172NP | 79.1172 | ● | ■ | ▲ |
| | 29 | 1" | 32 | 70.1154 | 70.1154NP | 79.1154 | 70.1174 | 70.1174NP | 79.1174 | ● | ■ | ▲ |
| 1 Entry with dust cover | 21 | 3/4" | 25 | 70.1142 | 70.1142NP | 79.1142 | 70.1162 | 70.1162NP | 79.1162 | ● | ■ | ▲ |
| | 29 | 1" | 32 | 70.1144 | 70.1144NP | 79.1144 | 70.1164 | 70.1164NP | 79.1164 | ● | ■ | ▲ |

HBE 16 CABLE COUPLER HOODS WITH SINGLE LEVER

STANDARD PROFILE

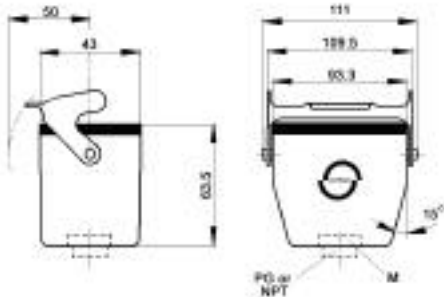

HIGH PROFILE

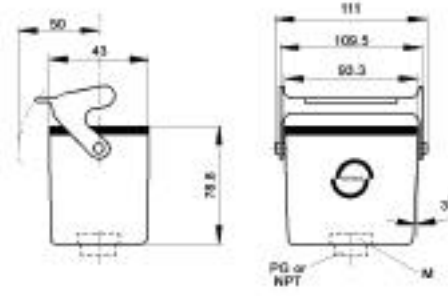

All dimensions are in mm.

| Profile | Size of Entry | | | Standard Grey Coating | | | Black Coating (NEMA 4X) | | | Strain Relief | | |
|----------|---------------|------|--------|-----------------------|------------|---------------|-------------------------|------------|---------------|---------------|-----|---|
| | PG | NPT | Metric | PG Part # | NPT Part # | Metric Part # | PG Part # | NPT Part # | Metric Part # | PG | NPT | M |
| Standard | 21 | 3/4" | 25 | 10.0869 | 10.0869NP | 19.0869 | 70.0930 | 70.0930NP | 79.0930 | ● | ■ | ▲ |
| | 29 | 1" | 32 | 10.0969 | 10.0969NP | 19.0969 | 70.0969 | 70.0969NP | 79.0969 | ● | ■ | ▲ |
| High | 21 | 3/4" | 25 | 70.0922 | 70.0922NP | 79.0922 | 70.0932 | 70.0932NP | 79.0932 | ● | ■ | ▲ |
| | 29 | 1" | 32 | 70.0924 | 70.0924NP | 79.0924 | 70.0934 | 70.0934NP | 79.0934 | ● | ■ | ▲ |

Metric hoods do not come with a neck.

www.contactelectronics.com
800-221-1451

Rectangular Connectors HDD Series

HBE 16 HOODS WITH DOUBLE LEVER BOLTS

TOP ENTRY

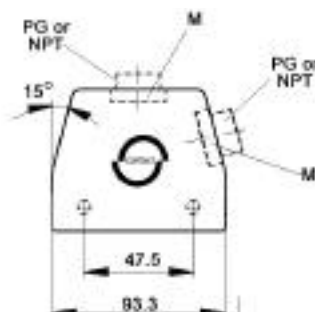
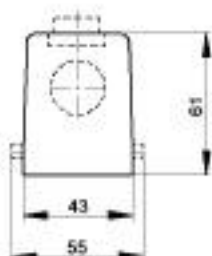

SIDE ENTRY



All dimensions are in mm.

| Position of Cable Entry | Size of Entry | | | Standard Grey Coating | | | Black Coating (NEMA 4X) | | | Strain Relief | | |
|-------------------------|---------------|------|--------|-----------------------|------------|---------------|-------------------------|------------|---------------|---------------|-----|---|
| | PG | NPT | Metric | PG Part # | NPT Part # | Metric Part # | PG Part # | NPT Part # | Metric Part # | PG | NPT | M |
| Top Entry | 21 | 3/4" | 25 | 10.0800 | 10.0800NP | 19.0800 | 70.1010 | 70.1010NP | 79.1010 | ● | ■ | ▲ |
| | 29 | 1" | 32 | 10.0900 | 10.0900NP | 19.0900 | - | - | - | ● | ■ | ▲ |
| Side Entry | 21 | 3/4" | 25 | 10.0820 | 10.0820NP | 19.0820 | 70.1030 | 70.1030NP | 79.1030 | ● | ■ | ▲ |
| | 29 | 1" | 32 | 10.0920 | 10.0920NP | 19.0920 | - | - | - | ● | ■ | ▲ |

Metric hoods do not come with a neck.

HBE 16 HIGH PROFILE HOODS WITH DOUBLE LEVER BOLTS

TOP ENTRY

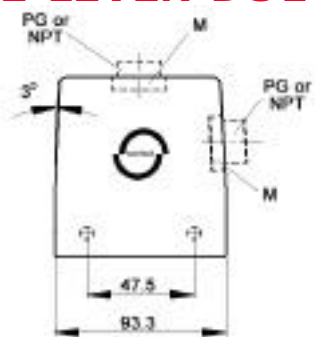

SIDE ENTRY



All dimensions are in mm.

| Position of Cable Entry | Size of Entry | | | Standard Grey Coating | | | Black Coating (NEMA 4X) | | | Strain Relief | | |
|-------------------------|---------------|------|--------|-----------------------|------------|---------------|-------------------------|------------|---------------|---------------|-----|---|
| | PG | NPT | Metric | PG Part # | NPT Part # | Metric Part # | PG Part # | NPT Part # | Metric Part # | PG | NPT | M |
| Top Entry | 21 | 3/4" | 25 | 70.1002 | 70.1002NP | 79.1002 | 70.1012 | 70.1012NP | 79.1012 | ● | ■ | ▲ |
| | 29 | 1" | 32 | 70.1004 | 70.1004NP | 79.1004 | 70.1014 | 70.1014NP | 79.1014 | ● | ■ | ▲ |
| Side Entry | 21 | 3/4" | 25 | 70.1022 | 70.1022NP | 79.1022 | 70.1032 | 70.1032NP | 79.1032 | ● | ■ | ▲ |
| | 29 | 1" | 32 | 70.1024 | 70.1024NP | 79.1024 | 70.1034 | 70.1034NP | 79.1034 | ● | ■ | ▲ |

Metric hoods do not come with a neck.

www.contactelectronics.com
800-221-1451

Rectangular Connectors HDD Series

HBE 16 PANEL MOUNT BASES WITH DOUBLE LEVERS

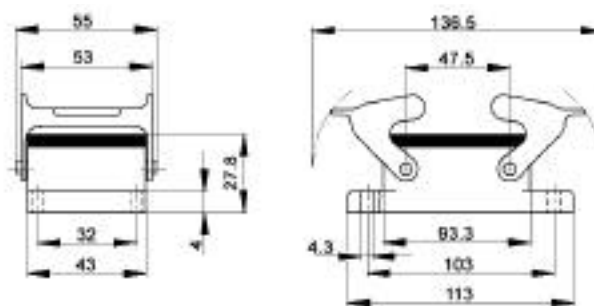

All dimensions are in mm.

| Description | Standard Grey Coating | Black Coating (NEMA 4X) |
|--------------------------------|-----------------------|-------------------------|
| Panel Mount without Dust Cover | 10.0720 | 70.0825 |

HBE 16 SURFACE MOUNT BASES WITH DOUBLE LEVERS

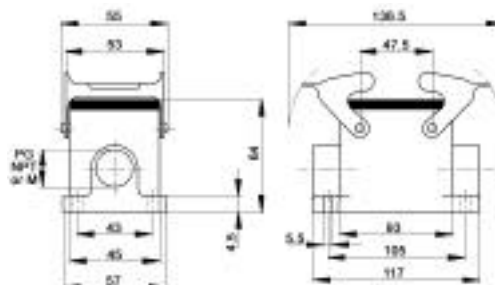
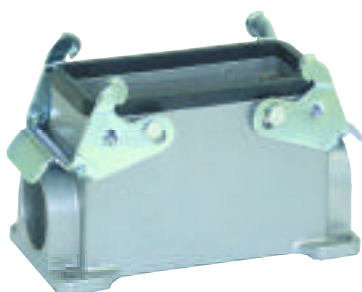

All dimensions are in mm.

| Mounting Type | Size of Entry | | | Standard Grey Coating | | | Black Coating (NEMA 4X) | | | Strain Relief | | |
|---------------|---------------|------|--------|-----------------------|------------|---------------|-------------------------|------------|---------------|---------------|-----|---|
| | PG | NPT | Metric | PG Part # | NPT Part # | Metric Part # | PG Part # | NPT Part # | Metric Part # | PG | NPT | M |
| 2 Entries | 21 | 3/4" | 25 | 10.0750 | 10.0750NP | 19.0750 | 70.0880 | 70.0880NP | 79.0880 | ● | ■ | ▲ |
| 1 Entry | 21 | 3/4" | 25 | 10.0740 | 10.0740NP | 19.0740 | 70.0870 | 70.0870NP | 79.0870 | ● | ■ | ▲ |

EMC PROTECTION



| | PG/NPT | Metric |
|------------------------------------|---------|---------|
| Panel Mount Base | 70.3502 | 79.3502 |
| Surface Mount & Cable Coupler Hood | 70.3522 | 79.3522 |

EMC Shielding is retrofittable.

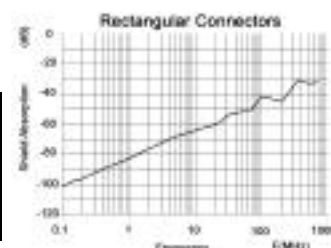

www.contactelectronics.com
800-221-1451

Rectangular Connectors HDD Series

HBE 16 HIGH PROFILE BASES WITH DOUBLE LEVERS

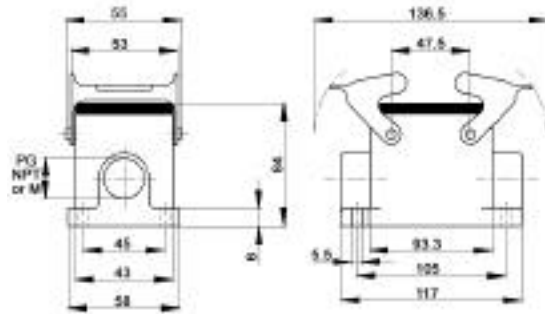

All dimensions are in mm.

| # of Entries | Size of Entry | | | Standard Grey Coating | | | Black Coating (NEMA 4X) | | | Strain Relief | | |
|--------------|---------------|------|--------|-----------------------|------------|---------------|-------------------------|------------|---------------|---------------|-----|---|
| | PG | NPT | Metric | PG Part # | NPT Part # | Metric Part # | PG Part # | NPT Part # | Metric Part # | PG | NPT | M |
| 2 Entries | 21 | 3/4" | 25 | 70.0862 | 70.0862NP | 79.0862 | 70.0882 | 70.0882NP | 79.0882 | | | |
| | 29 | 1" | 32 | 70.0864 | 70.0864NP | 79.0864 | 70.0884 | 70.0884NP | 79.0884 | | | |
| 1 Entry | 21 | 3/4" | 25 | 70.0852 | 70.0852NP | 79.0852 | 70.0872 | 70.0872NP | 79.0872 | | | |
| | 29 | 1" | 32 | 70.0854 | 70.0854NP | 79.0854 | 70.0874 | 70.0874NP | 79.0874 | | | |

HBE 16 CABLE COUPLER HOODS WITH DOUBLE LEVERS

STANDARD PROFILE

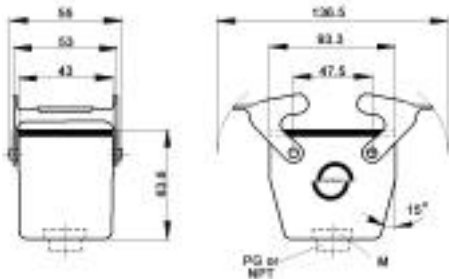

HIGH PROFILE

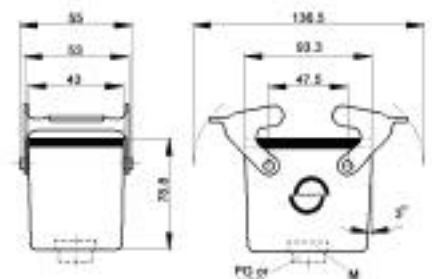

All dimensions are in mm.

| Profile | Size of Entry | | | Standard Grey Coating | | | Black Coating (NEMA 4X) | | | Strain Relief | | |
|----------|---------------|------|--------|-----------------------|------------|---------------|-------------------------|------------|---------------|---------------|-----|---|
| | PG | NPT | Metric | PG Part # | NPT Part # | Metric Part # | PG Part # | NPT Part # | Metric Part # | PG | NPT | M |
| Standard | 21 | 3/4" | 25 | 10.0860 | 10.0860NP | 19.0860 | 70.0910 | 70.0910NP | 79.0910 | | | |
| | 29 | 1" | 32 | 10.0960 | 10.0960NP | 19.0960 | - | - | - | | | |
| High | 21 | 3/4" | 25 | 70.0902 | 70.0902NP | 79.0902 | 70.0912 | 70.0912NP | 79.0912 | | | |
| | 29 | 1" | 32 | 70.0904 | 70.0904NP | 79.0904 | 70.0914 | 70.0914NP | 79.0914 | | | |

Metric hoods do not come with a neck.

www.contactelectronics.com
800-221-1451

Rectangular Connectors HDD Series

HBE 16 HOODS WITH DOUBLE LEVERS

TOP ENTRY

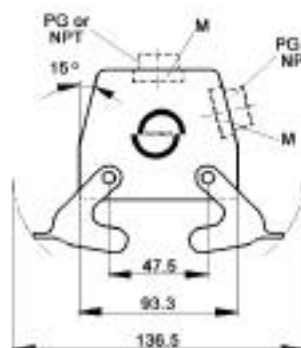
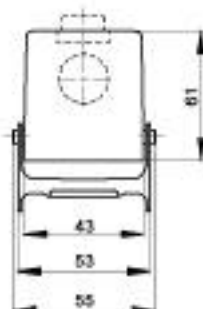

SIDE ENTRY



All dimensions are in mm.

| Position of Cable Entry | Size of Entry | | | Standard Grey Coating | | | Black Coating (NEMA 4X) | | | Strain Relief | | |
|-------------------------|---------------|------|--------|-----------------------|------------|---------------|-------------------------|------------|---------------|---------------|-----|---|
| | PG | NPT | Metric | PG Part # | NPT Part # | Metric Part # | PG Part # | NPT Part # | Metric Part # | PG | NPT | M |
| Top Entry | 21 | 3/4" | 25 | 10.0810 | 10.0810NP | 19.0810 | 70.1060 | 70.1060NP | 79.1060 | ● | ■ | ▲ |
| | 29 | 1" | 32 | 10.0910 | 10.0910NP | 19.0910 | - | - | - | ● | ■ | ▲ |
| Side Entry | 21 | 3/4" | 25 | 10.0830 | 10.0830NP | 19.0830 | 70.1080 | 70.1080NP | 79.1080 | ● | ■ | ▲ |
| | 29 | 1" | 32 | 10.0930 | 10.0930NP | 19.0930 | - | - | - | ● | ■ | ▲ |

Metric hoods do not come with a neck.

HBE 16 HIGH PROFILE HOODS WITH DOUBLE LEVERS

TOP ENTRY

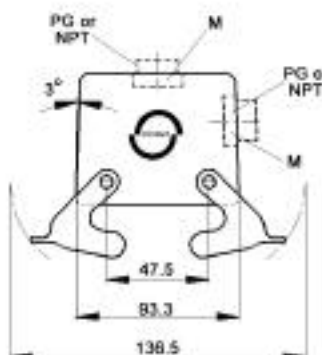
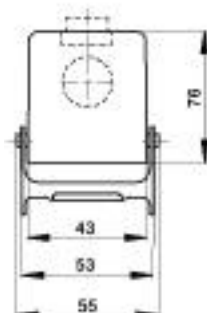

SIDE ENTRY



All dimensions are in mm.

| Position of Cable Entry | Size of Entry | | | Standard Grey Coating | | | Black Coating (NEMA 4X) | | | Strain Relief | | |
|-------------------------|---------------|------|--------|-----------------------|------------|---------------|-------------------------|------------|---------------|---------------|-----|---|
| | PG | NPT | Metric | PG Part # | NPT Part # | Metric Part # | PG Part # | NPT Part # | Metric Part # | PG | NPT | M |
| Top Entry | 21 | 3/4" | 25 | 70.1052 | 70.1052NP | 79.1052 | 70.1062 | 70.1062NP | 79.1062 | ● | ■ | ▲ |
| | 29 | 1" | 32 | 70.1054 | 70.1054NP | 79.1054 | 70.1064 | 70.1064NP | 79.1064 | ● | ■ | ▲ |
| Side Entry | 21 | 3/4" | 25 | 70.1072 | 70.1072NP | 79.1072 | 70.1082 | 70.1082NP | 79.1082 | ● | ■ | ▲ |
| | 29 | 1" | 32 | 70.1074 | 70.1074NP | 79.1074 | 70.1084 | 70.1084NP | 79.1084 | ● | ■ | ▲ |

Metric hoods do not come with a neck.

www.contactelectronics.com
800-221-1451

Rectangular Connectors HDD Series

HBE 16 PANEL MOUNT BASES WITH DOUBLE LEVER BOLTS

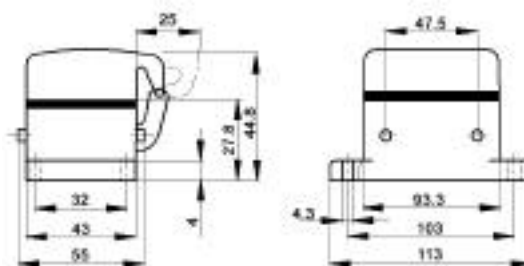

All dimensions are in mm.

| Description | Standard Grey Coating | Black Coating (NEMA 4X) |
|--------------------------------|-----------------------|-------------------------|
| Panel Mount with Dust Cover | 10.0730 | 70.0835 |
| Panel Mount without Dust Cover | 10.0731 | - |

HBE 16 SURFACE MOUNT BASES WITH DOUBLE LEVER BOLTS

STANDARD PROFILE

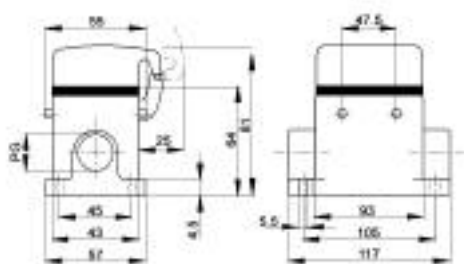

HIGH PROFILE

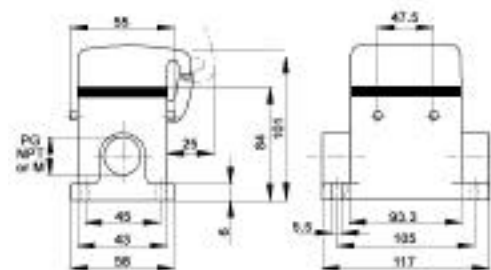

All dimensions are in mm.

| # of Entries | Size of Entry | | | Standard Grey Coating | | | Black Coating (NEMA 4X) | | | Strain Relief | | |
|-----------------------------|---------------|------|--------|-----------------------|------------|---------------|-------------------------|------------|---------------|---------------|-----|---|
| | PG | NPT | Metric | PG Part # | NPT Part # | Metric Part # | PG Part # | NPT Part # | Metric Part # | PG | NPT | M |
| 2 Entries | 21 | 3/4" | 25 | 70.0960 | 70.0960NP | 79.0960 | 70.0980 | 70.0980NP | 79.0980 | ● | ■ | ▲ |
| 1 Entry | 21 | 3/4" | 25 | 10.0760 | 10.0760NP | 19.0970 | 70.0970 | 70.0970NP | 79.0970 | ● | ■ | ▲ |
| High Profile with 2 Entries | 21 | 3/4" | 25 | 70.0962 | 70.0962NP | 79.0962 | 70.0982 | 70.0982NP | 79.0982 | ● | ■ | ▲ |
| | 29 | 1" | 32 | 70.0964 | 70.0964NP | 79.0964 | 70.0984 | 70.0984NP | 79.0984 | ● | ■ | ▲ |
| High Profile with 1 Entry | 21 | 3/4" | 25 | 70.0952 | 70.0952NP | 79.0952 | 70.0972 | 70.0972NP | 79.0972 | ● | ■ | ▲ |
| | 29 | 1" | 32 | 70.0954 | 70.0954NP | 79.0954 | 70.0974 | 70.0974NP | 79.0974 | ● | ■ | ▲ |

EMC PROTECTION



| | PG/NPT | Metric |
|------------------------------------|---------|---------|
| Panel Mount Base | 70.3502 | 79.3502 |
| Surface Mount & Cable Coupler Hood | 70.3522 | 79.3522 |

EMC Shielding is retrofitable.



www.contactelectronics.com
800-221-1451