

Rectangular Connectors HDD Series

HDD 24 CRIMP TERMINATED: MACHINE CONTACT

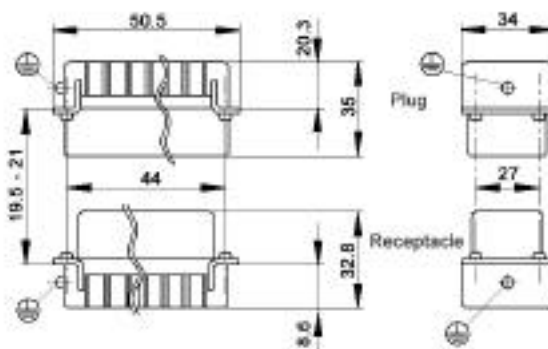

These inserts fit in the HBE
6 Series Housings which
are on the following pages.



All dimensions are in mm.

Plug	Receptacle
11.2850	11.2860

Contacts Sold Separately

View from Cable Side

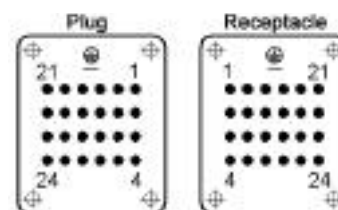

Panel Cut-Out

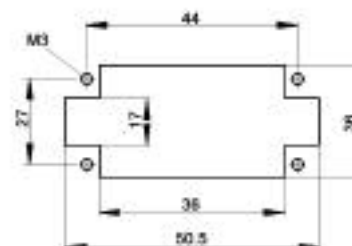

HDD MACHINED CONTACTS: DIAMETER 1.6 MM



Bags of 100								
mm2	AWG	Silver			Gold			Stripping Length
		Pin	Socket	Stripping Length	Pin	Socket	Stripping Length	
0.14 - 0.37	26 - 22	13.1620	13.1630	8	13.1625	13.1635	8	
0.5	20	13.1621	13.1631	8	13.1626	13.1636	8	
0.75 - 1.0	18	13.1622	13.1632	8	13.1627	13.1637	8	
1.5	16	13.1623	13.1633	8	13.1628	13.1638	8	
2.5	14	13.1624	13.1634	5.8	-	-	-	

TOOLS



Locator
11.1472



Crimp Dies
11.1471



Crimp Tool
11.1470



Removal Tool:
11.1610

www.contactelectronics.com
800-221-1451

Rectangular Connectors HDD Series

HBE 6 HOODS WITH SINGLE LEVER BOLTS

TOP ENTRY

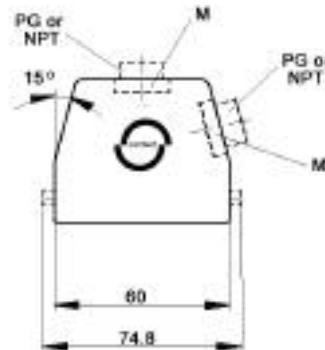

SIDE ENTRY



All dimensions are in mm.

Position of Cable Entry	Size of Entry			Standard Grey Coating			Black Coating (NEMA 4X)			Strain Relief		
	PG	NPT	Metric	PG Part #	NPT Part #	Metric Part #	PG Part #	NPT Part #	Metric Part #	PG	NPT	M
Top Entry	13.5	1/2"	20	10.0110	10.0110NP	19.0110	70.0216	70.0216NP	79.0216	●	■	▲
	16	1/2"	25	10.0210	10.0210NP	19.0210	70.0210	70.0210NP	79.0210	●	■	▲
Side Entry	13.5	1/2"	20	10.0120	10.0120NP	19.0120	70.0236	70.0236NP	79.0236	●	■	▲
	16	1/2"	25	10.0220	10.0220NP	19.0220	70.0230	70.0230NP	79.0230	●	■	▲

Metric hoods do not come with a neck.

HBE 6 HIGH PROFILE HOODS WITH SINGLE LEVER BOLTS

TOP ENTRY

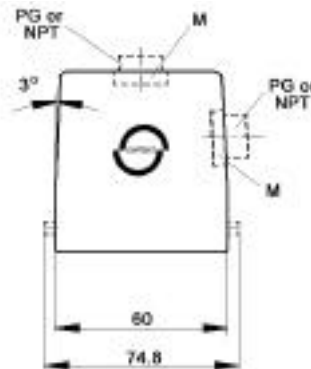
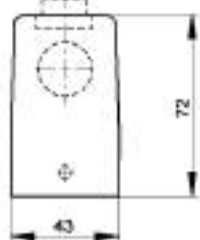

SIDE ENTRY



All dimensions are in mm.

Position of Cable Entry	Size of Entry			Standard Grey Coating			Black Coating (NEMA 4X)			Strain Relief		
	PG	NPT	Metric	PG Part #	NPT Part #	Metric Part #	PG Part #	NPT Part #	Metric Part #	PG	NPT	M
Top Entry	21	3/4"	25	70.0202	70.0202NP	79.0202	70.0212	70.0212NP	79.0212	●	■	▲
	29	1"	32	70.0204	70.0204NP	79.0204	70.0214	70.0214NP	79.0214	●	■	▲
Side Entry	21	3/4"	25	70.0222	70.0222NP	79.0222	70.0232	70.0232NP	79.0232	●	■	▲
	29	1"	32	70.0224	70.0224NP	79.0224	70.0234	70.0234NP	79.0234	●	■	▲

Metric hoods do not come with a neck.

www.contactelectronics.com
800-221-1451

Rectangular Connectors HDD Series

HBE 6 PANEL MOUNT BASES WITH SINGLE LEVER

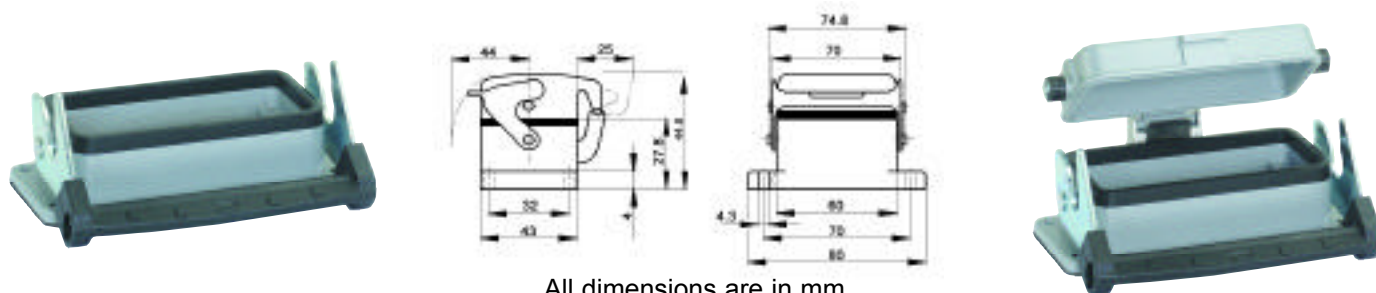

All dimensions are in mm.

Description	Standard Grey Coating	Black Coating (NEMA 4X)
Panel Mount without Dust Cover	10.0030	70.0025
Panel Mount with Dust Cover	10.0040	70.0045

HBE 6 SURFACE MOUNT BASES WITH SINGLE LEVER

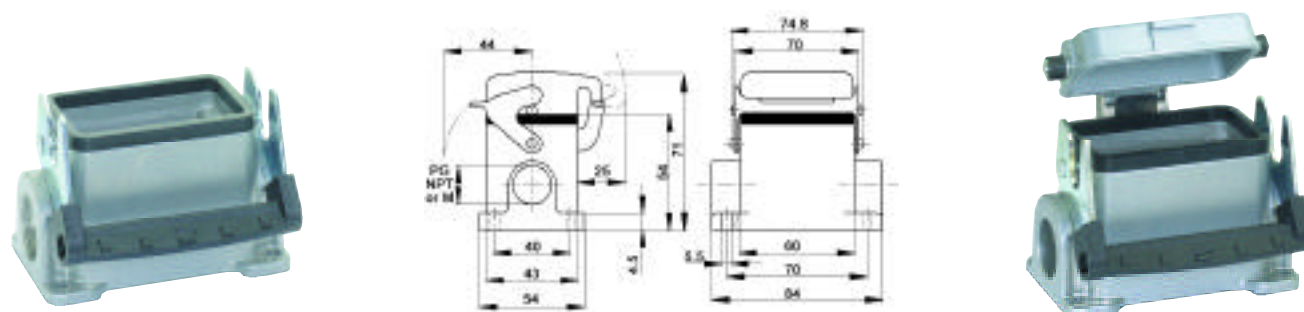

All dimensions are in mm.

# of Entries	Size of Entry			Standard Grey Coating			Black Coating (NEMA 4X)			Strain Relief		
	PG	NPT	Metric	PG Part #	NPT Part #	Metric Part #	PG Part #	NPT Part #	Metric Part #	PG	NPT	M
2 Entries	16	1/2"	20	10.0060	10.0060NP	19.0060	70.0080	70.0080NP	79.0080	●	■	▲
			25			79.0066			79.0086			▲
1 Entry	16	1/2"	20	10.0050	10.0050NP	19.0050	70.0070	70.0070NP	79.0070	●	■	▲
			25			79.0056			79.0076			▲
2 Entries with dust cover	16	1/2"	20	10.0090	10.0090NP	19.0090	70.0180	70.0180NP	79.0180	●	■	▲
			25			79.0166			79.0186			▲
1 Entry with dust cover	16	1/2"	20	10.0070	10.0070NP	19.0070	70.0170	70.0170NP	79.0170	●	■	▲
			25			79.0156			79.0176			▲

EMC PROTECTION



	PG/NPT	Metric
Panel Mount Base	70.3500	79.3500
Surface Mount & Cable Coupler Hood	70.3520	79.3520

EMC Shielding is retrofittable.

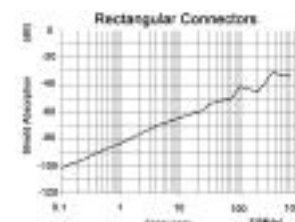

www.contactelectronics.com
800-221-1451

Rectangular Connectors HDD Series

HBE 6 HIGH PROFILE SURFACE MOUNT BASES WITH SINGLE LEVER

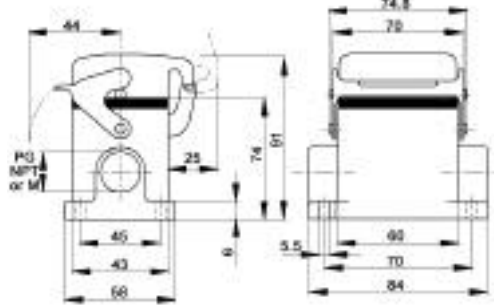
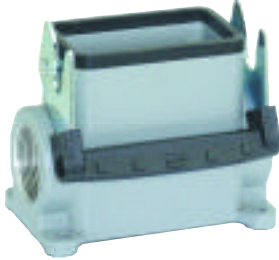

All dimensions are in mm.



# of Entries	Size of Entry			Standard Grey Coating			Black Coating (NEMA 4X)			Strain Relief		
	PG	NPT	Metric	PG Part #	NPT Part #	Metric Part #	PG Part #	NPT Part #	Metric Part #	PG	NPT	M
2 Entries	21	3/4"	25	70.0062	70.0062NP	79.0062	70.0082	70.0082NP	79.0082	●	■	▲
	29	1"	32	70.0064	70.0064NP	79.0064	70.0084	70.0084NP	79.0084	●	■	▲
1 Entry	21	3/4"	25	70.0052	70.0052NP	79.0052	70.0072	70.0072NP	79.0072	●	■	▲
	29	1"	32	70.0054	70.0054NP	79.0054	70.0074	70.0074NP	79.0074	●	■	▲
2 Entries with dust cover	21	3/4"	25	70.0162	70.0162NP	79.0162	70.0182	70.0182NP	79.0182	●	■	▲
	29	1"	32	70.0164	70.0164NP	79.0164	70.0184	70.0184NP	79.0184	●	■	▲
1 Entry with dust cover	21	3/4"	25	70.0152	70.0152NP	79.0152	70.0172	70.0172NP	79.0172	●	■	▲
	29	1"	32	70.0154	70.0154NP	79.0154	70.0174	70.0174NP	79.0174	●	■	▲

HBE 6 CABLE COUPLER HOOD WITH SINGLE LEVER

STANDARD PROFILE

HIGH PROFILE

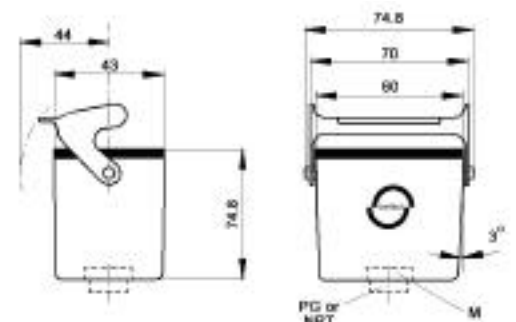
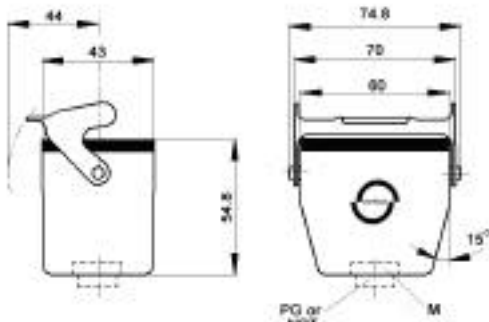

Profile	Size of Entry			Standard Grey Coating			Black Coating (NEMA 4X)			Strain Relief		
	PG	NPT	Metric	PG Part #	NPT Part #	Metric Part #	PG Part #	NPT Part #	Metric Part #	PG	NPT	M
Standard Profile	13.5	1/2"	20	10.0140	10.0140NP	19.0140	-	-	79.0110	●	■	▲
	16	1/2"	25	10.0240	10.0240NP	19.0240	70.0110	70.0110NP	79.0116	●	■	▲
High Profile	21	3/4"	25	70.0102	70.0102NP	79.0102	70.0112	70.0112NP	79.0112	●	■	▲
	29	1"	32	70.0104	70.0104NP	79.0104	70.0114	70.0114NP	79.0114	●	■	▲

Metric hoods do not come with a neck.

www.contactelectronics.com
800-221-1451