

Rectangular Connectors HD Series

HD 64 CRIMP TERMINATED: MACHINE CONTACT INSERTS

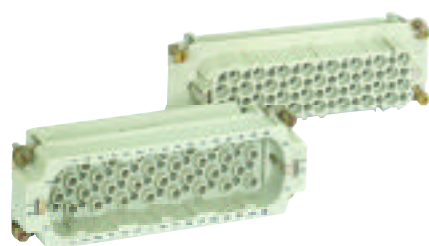

Contacts Sold Separately

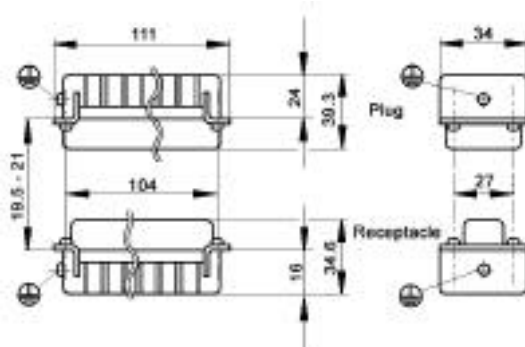

All dimensions are in mm.

View from cable side

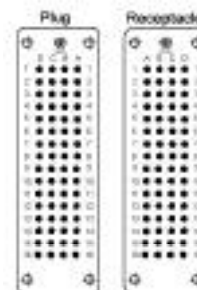

These inserts fit in the HBE 24 Series Housings which are on the following pages.

Plug	Receptacle
11.2720	11.2730

MACHINED CONTACTS: DIAMETER 1.6MM



Bags of 100							
mm2	AWG	Silver			Gold		
		Pin	Socket	Stripping Length	Pin	Socket	Stripping Length
0.14 - 0.37	26 - 22	13.1620	13.1630	8	13.1625	13.1635	8
0.5	20	13.1621	13.1631	8	13.1626	13.1636	8
0.75 - 1.0	18	13.1622	13.1632	8	13.1627	13.1637	8
1.5	16	13.1623	13.1633	8	13.1628	13.1638	8
2.5	14	13.1624	13.1634	5.8	-	-	-

TOOLS

WIRE GAUGE: 0.14 - 2.5 MM2



Locator
11.1472



Crimp Dies
11.1471



Crimp Tool
11.1470



Removal Tool:
11.1610

www.contactelectronics.com
800-221-1451

Rectangular Connectors HD Series

HD 64 CRIMP TERMINATED: STAMPED & FORMED CONTACT



Contacts Sold Separately

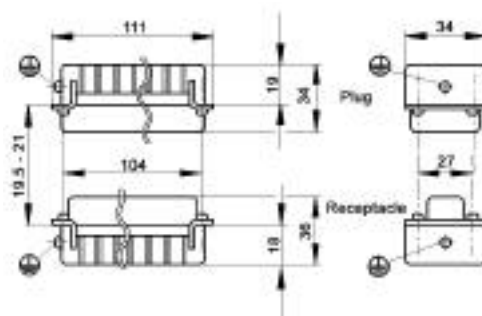

All dimensions are in mm.

Plug	Receptacle
11.2700	11.2710

Panel Cut-Out

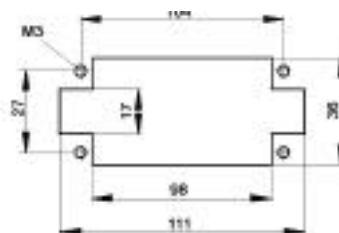

These inserts fit in the HBE 24 Series Housings which are on the following pages.

STAMPED & FORMED CONTACTS: DIAMETER 1.6MM



Reel feeds from left.

mm2	AWG	Bags of 100				Reels of 200		Stripping Length
		Silver		Gold		Silver		
		Pin	Socket	Pin	Socket	Pin	Socket	
0.14 - 0.5	26 - 20	11.2411	11.2311	11.2431	11.2331	11.2407	11.2307	2.5 - 0.5
0.5 - 1.5	20 - 16	11.2210	11.2361	11.2213	11.2381	11.2207	11.2357	3.5 - 0.5
1.5 - 2.5	16 - 14	11.2235	11.2285	-	-	11.2230	11.2280	3.5 - 0.5

TOOLS

WIRE GAUGE: 0.14 - 2.5 MM2



Crimp Tool
11.1470



Locator
11.1473



Removal Tool:
11.1610



Crimp Tool for Reel:
11.1535



Crimp Dies

0.14-0.5:	11.147170
0.5-1.5:	11.147180
1.5-2.5:	11.147190

Crimp Dies for Reel:

0.14-0.5:	11.1536
0.5-1.5:	11.1537
1.5-2.5:	11.1538

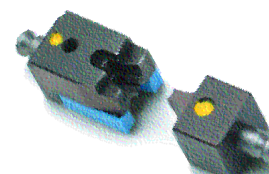

www.contactelectronics.com
800-221-1451

Rectangular Connectors HD Series

HD 64 TERMINAL BLOCK ADAPTER INSERTS

1

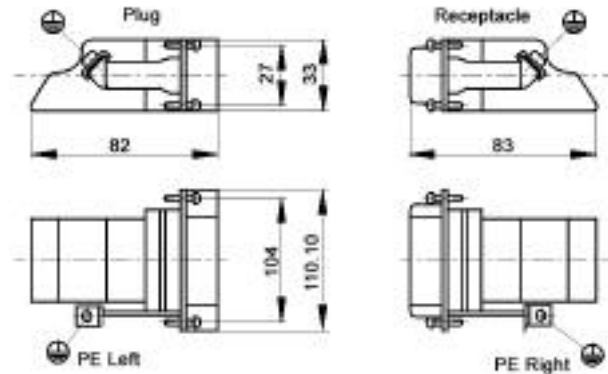
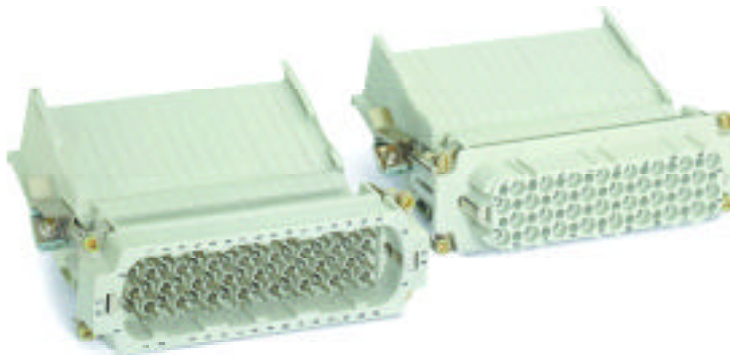

All dimensions are in mm.

View from cable side

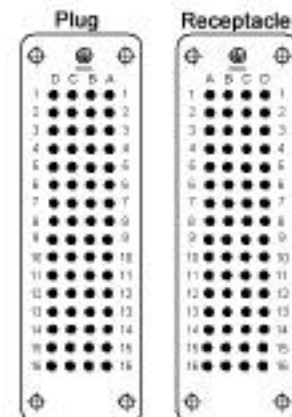

These terminal block inserts only fit
in HBE 24 panel mount bases

One terminal block insert mates with
one screw terminated insert.

	Plug	Receptacle
Terminal Block Right Ground	71.3060	71.3071
Terminal Block Left Ground	71.3070	71.3061

Rectangular Connectors HD Series

HBE 24 HOODS WITH SINGLE LEVER BOLTS

TOP ENTRY

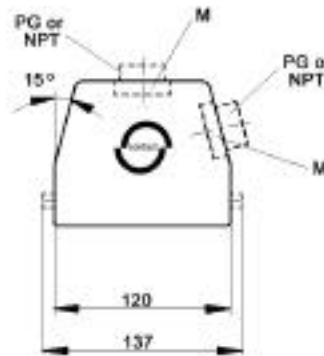
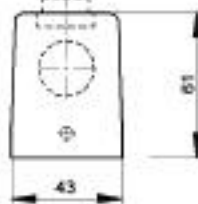

SIDE ENTRY



All dimensions are in mm.

Position of Cable Entry	Size of Entry			Standard Grey Coating			Black Coating (NEMA 4X)			Strain Relief
	PG	NPT	Metric	PG Part #	NPT Part #	Metric Part #	PG Part #	NPT Part #	Metric Part #	
Top Entry	21	3/4"	25	10.1219	10.1219NP	19.1219	70.1490	70.1490NP	79.1490	PG NPT M
	29	1"	32	10.1119	10.1119NP	19.1119	70.1492	70.1492NP	79.1492	PG NPT M
Side Entry	21	3/4"	25	10.1139	10.1139NP	19.1139	70.1590	70.1590NP	79.1590	PG NPT M
	29	1"	32	10.1239	10.1239NP	19.1239	70.1592	70.1592NP	79.1592	PG NPT M

Metric hoods do not come with a neck.

HBE 24 HIGH PROFILE HOODS WITH SINGLE LEVER BOLTS

TOP ENTRY

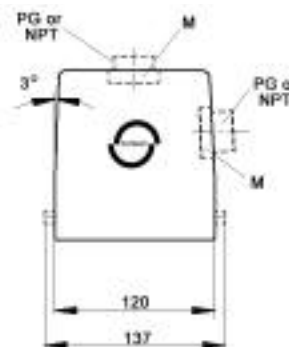
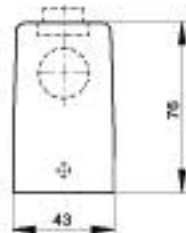

SIDE ENTRY



All dimensions are in mm.

Position of Cable Entry	Size of Entry			Standard Grey Coating			Black Coating (NEMA 4X)			Strain Relief
	PG	NPT	Metric	PG Part #	NPT Part #	Metric Part #	PG Part #	NPT Part #	Metric Part #	
Top Entry	21	3/4"	25	70.1444	70.1444NP	79.1444	70.1494	70.1494NP	79.1494	PG NPT M
	29	1"	32	70.1446	70.1446NP	79.1446	70.1496	70.1496NP	79.1496	PG NPT M
Side Entry	21	3/4"	25	70.1544	70.1544NP	79.1544	70.1594	70.1594NP	79.1594	PG NPT M
	29	1"	32	70.1546	70.1546NP	79.1546	70.1596	70.1596NP	79.1596	PG NPT M

Metric hoods do not come with a neck.

www.contactelectronics.com
800-221-1451

Rectangular Connectors HD Series

HBE 24 PANEL MOUNT BASES WITH SINGLE LEVER

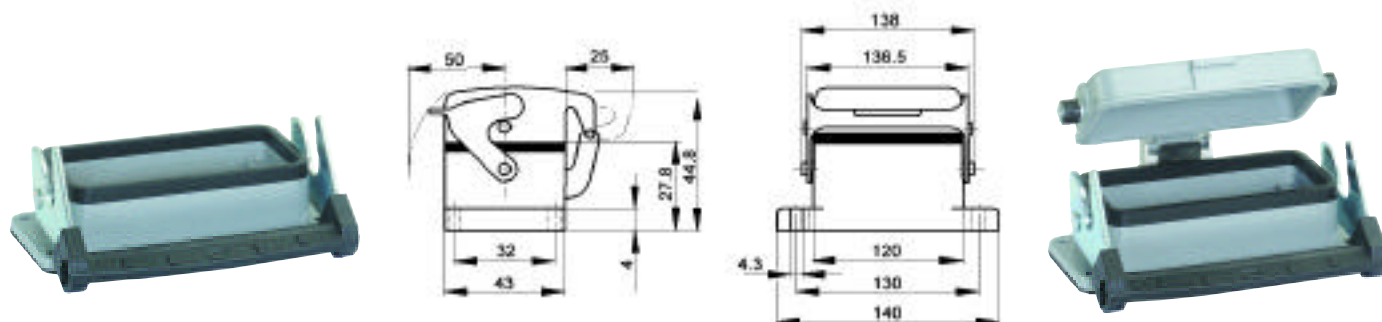

All dimensions are in mm.

Description	Standard Grey Coating	Black Coating (NEMA 4X)
Panel Mount without dust cover	10.1029	70.1327
Panel Mount with dust cover	10.1039	70.1337

HBE 24 SURFACE MOUNT BASES WITH SINGLE LEVER

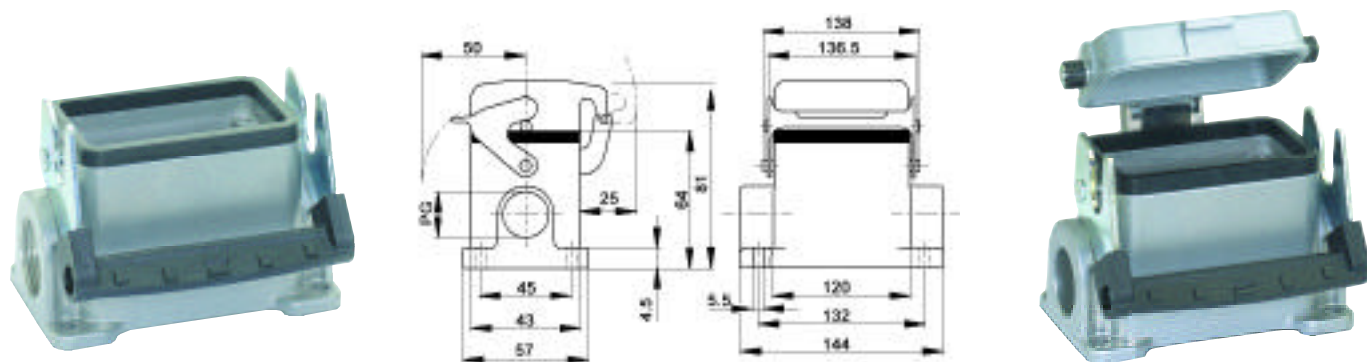

All dimensions are in mm.

# of Entries	Size of Entry			Standard Grey Coating			Black Coating (NEMA 4X)			Strain Relief		
	PG	NPT	Metric	PG Part #	NPT Part #	Metric Part #	PG Part #	NPT Part #	Metric Part #	PG	NPT	M
2 Entries	21	3/4"	25	10.1059	10.1059NP	19.1059	70.1630	70.1630NP	79.1630	●	■	▲
1 Entry	21	3/4"	25	10.1049	10.1049NP	19.1049	70.1620	70.1620NP	79.1620	●	■	▲
2 with cover	21	3/4"	25	10.1099	10.1099NP	19.1099	70.1670	70.1670NP	79.1670	●	■	▲
1 with cover	21	3/4"	25	10.1079	10.1079NP	19.1079	70.1660	70.1660NP	79.1660	●	■	▲

EMC PROTECTION



	PG/NPT	Metric
Panel Mount Base	70.3503	79.3503
Surface Mount & Cable Coupler Hood	70.3523	79.3523

EMC Shielding is retrofittable.

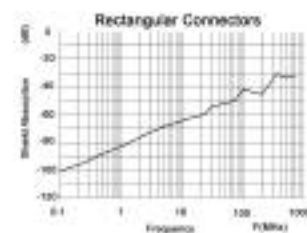

www.contactelectronics.com
800-221-1451

Rectangular Connectors HD Series

HBE 24 HIGH PROFILE SURFACE MOUNT BASES WITH SINGLE LEVER

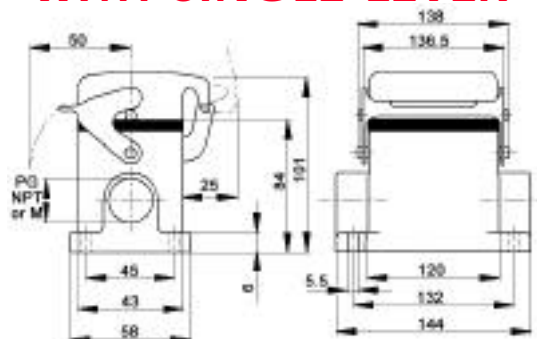

All dimensions are in mm.

# of Entries	Size of Entry			Standard Grey Coating			Black Coating (NEMA 4X)			Strain Relief		
	PG	NPT	Metric	PG Part #	NPT Part #	Metric Part #	PG Part #	NPT Part #	Metric Part #	PG	NPT	M
2 Entries	21	3/4"	25	70.1612	70.1612NP	79.1612	70.1632	70.1632NP	79.1632	●	■	▲
	29	1"	32	70.1614	70.1614NP	79.1614	70.1634	70.1634NP	79.1634	●	■	▲
1 Entry	21	3/4"	25	70.1602	70.1602NP	79.1602	70.1622	70.1622NP	79.1622	●	■	▲
	29	1"	32	70.1604	70.1604NP	79.1604	70.1624	70.1624NP	79.1624	●	■	▲
2 Entries with dust cover	21	3/4"	25	70.1652	70.1652NP	79.1652	70.1672	70.1672NP	79.1672	●	■	▲
	29	1"	32	70.1654	70.1654NP	79.1654	70.1674	70.1674NP	79.1674	●	■	▲
1 Entry with dust cover	21	3/4"	25	70.1642	70.1642NP	79.1642	70.1662	70.1662NP	79.1662	●	■	▲
	29	1"	32	70.1644	70.1644NP	79.1644	70.1664	70.1664NP	79.1664	●	■	▲

HBE 24 CABLE COUPLER HOODS WITH SINGLE LEVER

STANDARD PROFILE

HIGH PROFILE

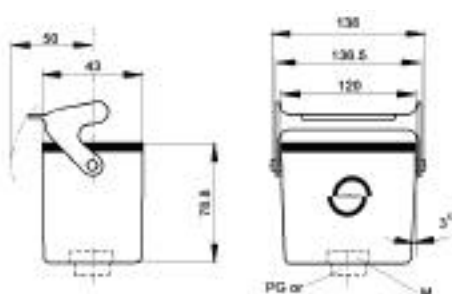
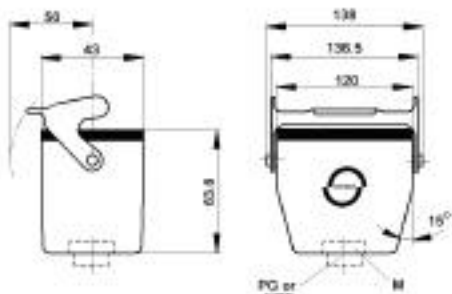

All dimensions are in mm.

Profile	Size of Entry			Standard Grey Coating			Black Coating (NEMA 4X)			Strain Relief		
	PG	NPT	Metric	PG Part #	NPT Part #	Metric Part #	PG Part #	NPT Part #	Metric Part #	PG	NPT	M
Standard	21	3/4"	25	10.1279	10.1279NP	19.1279	70.1430	70.1430NP	79.1430	●	■	▲
	29	1"	32	10.1179	10.1179NP	19.1179	70.1432	70.1432NP	79.1432	●	■	▲
High Profile	21	3/4"	25	70.1424	70.1424NP	79.1424	70.1434	70.1434NP	79.1434	●	■	▲
	29	1"	32	70.1426	70.1426NP	79.1426	70.1436	70.1436NP	79.1436	●	■	▲

Metric hoods do not come with a neck.

www.contactelectronics.com
800-221-1451

Rectangular Connectors HD Series

HBE 24 HOODS WITH DOUBLE LEVER BOLTS

TOP ENTRY

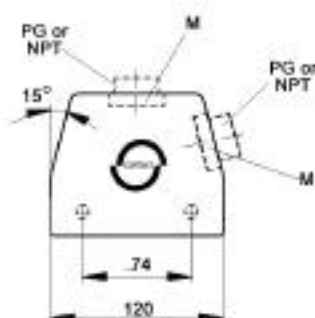
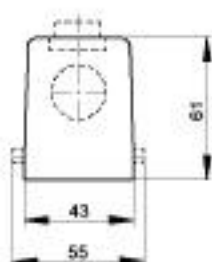

SIDE ENTRY



All dimensions are in mm.

Position of Cable Entry	Size of Entry			Standard Grey Coating			Black Coating (NEMA 4X)			Strain Relief		
	PG	NPT	Metric	PG Part #	NPT Part #	Metric Part #	PG Part #	NPT Part #	Metric Part #	PG	NPT	M
Top Entry	21	3/4"	25	10.1210	10.1210NP	19.1210	70.1510	70.1510NP	79.1510	●	■	▲
	29	1"	32	10.1110	10.1110NP	19.1110	70.1512	70.1512NP	79.1512	●	■	▲
Side Entry	21	3/4"	25	10.1130	10.1130NP	19.1130	70.1530	70.1530NP	79.1530	●	■	▲
	29	1"	32	10.1230	10.1230NP	19.1230	70.1532	70.1532NP	79.1532	●	■	▲

Metric hoods do not come with a neck.

HBE 24 HIGH PROFILE HOODS WITH DOUBLE LEVER BOLTS

TOP ENTRY

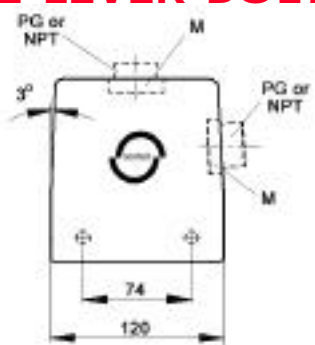

SIDE ENTRY



All dimensions are in mm.

Position of Cable Entry	Size of Entry			Standard Grey Coating			Black Coating (NEMA 4X)			Strain Relief		
	PG	NPT	Metric	PG Part #	NPT Part #	Metric Part #	PG Part #	NPT Part #	Metric Part #	PG	NPT	M
Top Entry	21	3/4"	25	70.1504	70.1504NP	79.1504	70.1514	70.1514NP	79.1514	●	■	▲
	29	1"	32	70.1506	70.1506NP	79.1506	70.1516	70.1516NP	79.1516	●	■	▲
Side Entry	21	3/4"	25	70.1524	70.1524NP	79.1524	70.1534	70.1534NP	79.1534	●	■	▲
	29	1"	32	70.1526	70.1526NP	79.1526	70.1536	70.1536NP	79.1536	●	■	▲

Metric hoods do not come with a neck.

www.contactelectronics.com
800-221-1451

Rectangular Connectors HD Series

HBE 24 PANEL MOUNT BASES WITH DOUBLE LEVERS

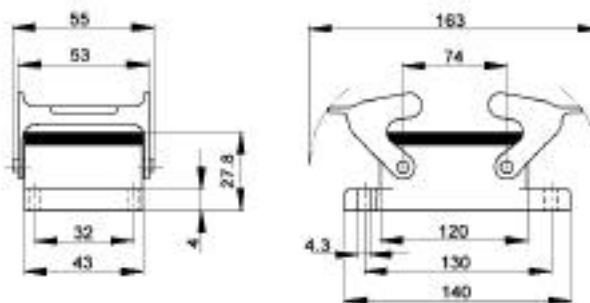

All dimensions are in mm.

Description	Standard Grey Coating	Black Coating (NEMA 4X)
Panel Mount without Dust Cover	10.1020	70.1325

HBE 24 SURFACE MOUNT BASES WITH DOUBLE LEVERS

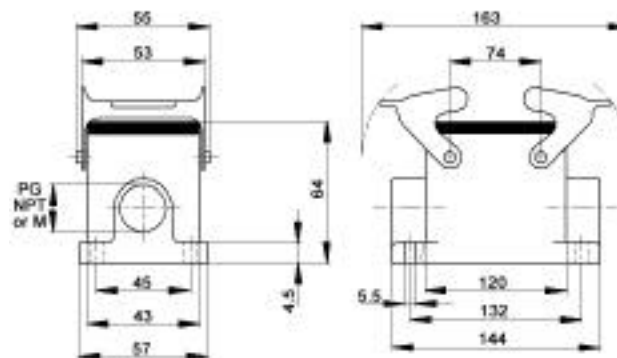
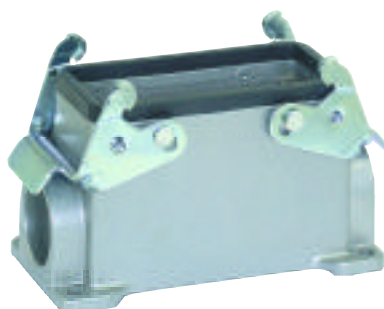

All dimensions are in mm.

# of Entries	Size of Entry			Standard Grey Coating			Black Coating (NEMA 4X)			Strain Relief		
	PG	NPT	Metric	PG Part #	NPT Part #	Metric Part #	PG Part #	NPT Part #	Metric Part #	PG	NPT	M
2 Entries	21	3/4"	25	10.1050	10.1050NP	19.1050	70.1380	70.1380NP	79.1380	●	■	▲
1 Entry	21	3/4"	25	10.1040	10.1040NP	19.1040	70.1370	70.1370NP	79.1370	●	■	▲

EMC PROTECTION



	PG/NPT	Metric
Panel Mount Base	70.3503	79.3503
Surface Mount & Cable Coupler Hood	70.3523	79.3523

EMC Shielding is retrofittable.

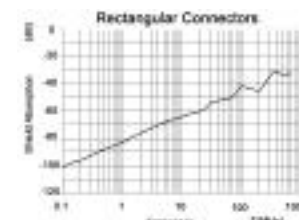

www.contactelectronics.com
800-221-1451

Rectangular Connectors HD Series

HBE 24 HIGH PROFILE SURFACE MOUNT BASES WITH DOUBLE LEVERS

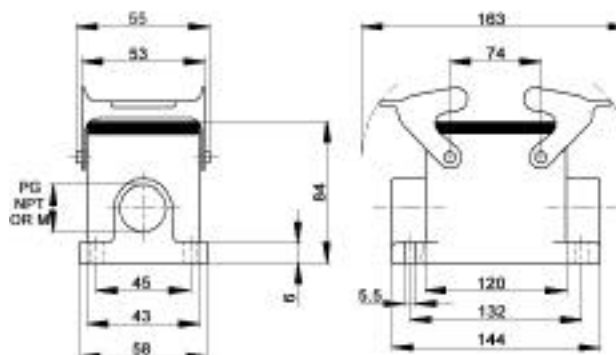
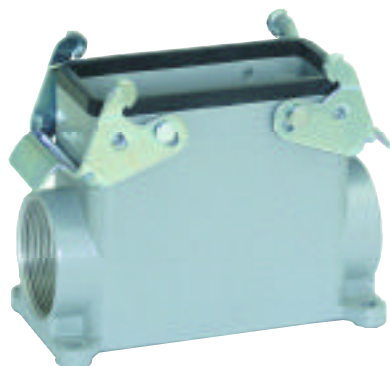

All dimensions are in mm.

Position of Cable Entry	Size of Entry			Standard Grey Coating			Black Coating (NEMA 4X)			Strain Relief
	PG	NPT	Metric	PG Part #	NPT Part #	Metric Part #	PG Part #	NPT Part #	Metric Part #	
2 Entries	21	3/4"	25	70.1362	70.1362NP	79.1362	70.1382	70.1382NP	79.1382	PG NPT M
	29	1"	32	70.1364	70.1364NP	79.1364	70.1384	70.1384NP	79.1384	PG NPT M
1 Entry	21	3/4"	25	70.1352	70.1352NP	79.1352	70.1372	70.1372NP	79.1372	PG NPT M
	29	1"	32	70.1354	70.1354NP	79.1354	70.1374	70.1374NP	79.1374	PG NPT M

HBE 24 CABLE COUPLER HOOD WITH DOUBLE LEVERS

STANDARD PROFILE

HIGH PROFILE

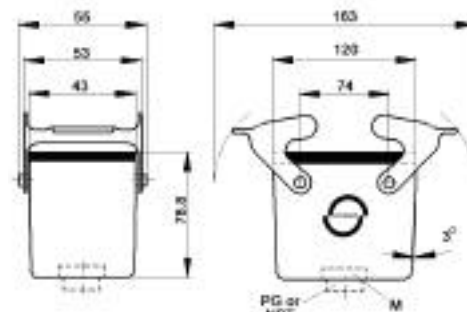
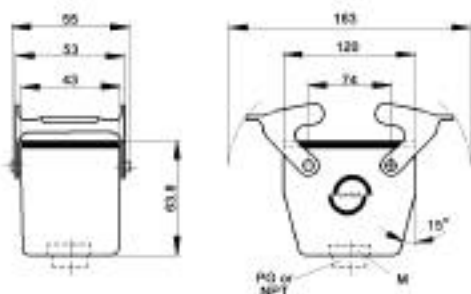

All dimensions are in mm.

Profile	Size of Entry			Standard Grey Coating			Black Coating (NEMA 4X)			Strain Relief
	PG	NPT	Metric	PG Part #	NPT Part #	Metric Part #	PG Part #	NPT Part #	Metric Part #	
Standard	21	3/4"	25	10.1270	10.1270NP	19.1270	70.1410	70.1410NP	79.1410	PG NPT M
	29	1"	32	10.1170	10.1170NP	19.1170	70.1412	70.1412NP	79.1412	PG NPT M
High Profile	21	3/4"	25	70.1404	70.1404NP	79.1404	70.1414	70.1414NP	79.1414	PG NPT M
	29	1"	32	70.1406	70.1406NP	79.1406	70.1416	70.1416NP	79.1416	PG NPT M

Metric hoods do not come with a neck.

www.contactelectronics.com
800-221-1451

Rectangular Connectors HD Series

HBE 24 HOODS WITH DOUBLE LEVERS

TOP ENTRY

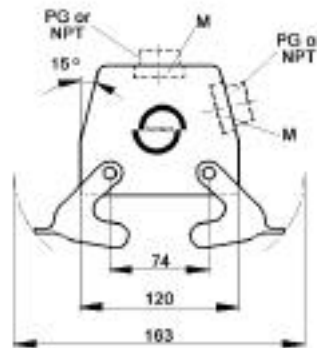
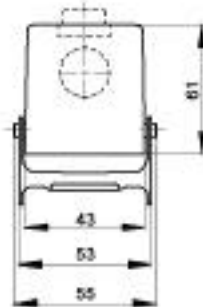

SIDE ENTRY



All dimensions are in mm.

Position of Cable Entry	Size of Entry			Standard Grey Coating			Black Coating (NEMA 4X)			Strain Relief		
	PG	NPT	Metric	PG Part #	NPT Part #	Metric Part #	PG Part #	NPT Part #	Metric Part #	PG	NPT	M
Top Entry	21	3/4"	25	10.1220	10.1220NP	19.1220	70.1560	70.1560NP	79.1560	●	■	▲
	29	1"	32	10.1120	10.1120NP	19.1120	70.1562	70.1562NP	79.1562	●	■	▲
Side Entry	21	3/4"	25	10.1140	10.1140NP	19.1140	70.1580	70.1580NP	79.1580	●	■	▲
	29	1"	32	10.1240	10.1240NP	19.1240	70.1582	70.1582NP	79.1582	●	■	▲

Metric hoods do not come with a neck.

HBE 24 HIGH PROFILE HOODS WITH DOUBLE LEVERS

TOP ENTRY

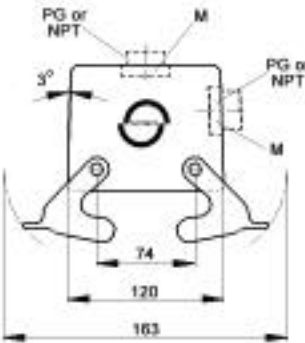
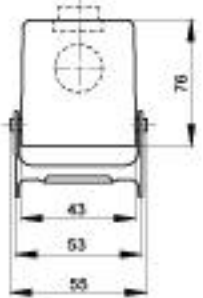

SIDE ENTRY



All dimensions are in mm.

Position of Cable Entry	Size of Entry			Standard Grey Coating			Black Coating (NEMA 4X)			Strain Relief		
	PG	NPT	Metric	PG Part #	NPT Part #	Metric Part #	PG Part #	NPT Part #	Metric Part #	PG	NPT	M
Top Entry	21	3/4"	25	70.1554	70.1554NP	79.1554	70.1564	70.1564NP	79.1564	●	■	▲
	29	1"	32	70.1556	70.1556NP	79.1556	70.1566	70.1566NP	79.1566	●	■	▲
Side Entry	21	3/4"	25	70.1574	70.1574NP	79.1574	70.1584	70.1584NP	79.1584	●	■	▲
	29	1"	32	70.1576	70.1576NP	79.1576	70.1586	70.1586NP	79.1586	●	■	▲

Metric hoods do not come with a neck.

www.contactelectronics.com
800-221-1451

Rectangular Connectors HD Series

HBE 24 PANEL MOUNT BASES WITH DOUBLE LEVER BOLTS

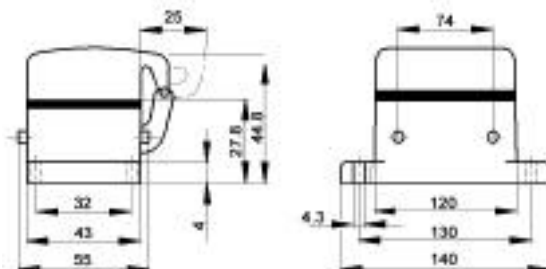

All dimensions are in mm.

Description	Standard Grey Coating	Black Coating (NEMA 4X)
Panel Mount with Dust cover	10.1030	70.1335
Panel Mount without cover	10.1031	-

HBE 24 SURFACE MOUNT BASES WITH DOUBLE LEVER BOLTS

STANDARD PROFILE

HIGH PROFILE

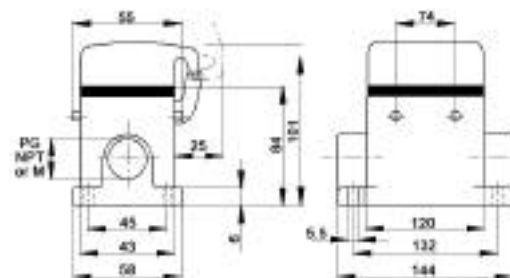
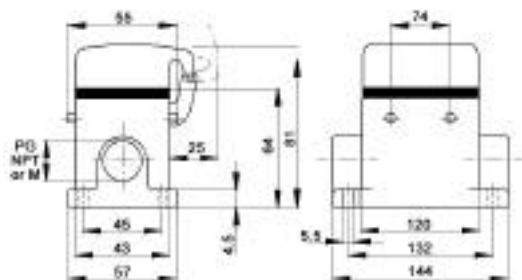

All dimensions are in mm.

# of Entries	Size of Entry			Standard Grey Coating			Black Coating (NEMA 4X)			Strain Relief
	PG	NPT	Metric	PG Part #	NPT Part #	Metric Part #	PG Part #	NPT Part #	Metric Part #	
2 Entries	21	3/4"	25	10.1090	10.1090NP	19.1090	70.1480	70.1480NP	79.1480	● ■ ▲
1 Entry	21	3/4"	25	10.1070	10.1070NP	19.1070	70.1470	70.1470NP	79.1470	● ■ ▲
High Profile with 2 Entries	21	3/4"	25	70.1462	70.1462NP	79.1462	70.1482	70.1482NP	79.1482	● ■ ▲
	29	1"	32	70.1464	70.1464NP	79.1464	70.1484	70.1484NP	79.1484	● ■ ▲
High Profile with 1 Entry	21	3/4"	25	70.1452	70.1452NP	79.1452	70.1472	70.1472NP	79.1472	● ■ ▲
	29	1"	32	70.1454	70.1454NP	79.1454	70.1474	70.1474NP	79.1474	● ■ ▲

EMC PROTECTION



	PG/NPT	Metric
Panel Mount Base	70.3503	79.3503
Surface Mount & Cable Coupler Hood	70.3523	79.3523

EMC Shielding is retrofitable.

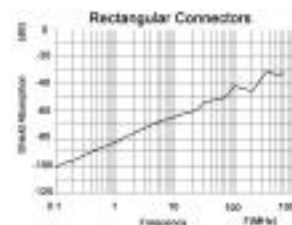

www.contactelectronics.com
800-221-1451