

THE INFORMATION CONTAINED IN THIS DRAWING IS THE SOLE PROPERTY OF ANDERSON POWER PRODUCTS. ANY REPRODUCTION IN PART OR WHOLE WITHOUT THE WRITTEN PERMISSION OF ANDERSON POWER PRODUCTS IS PROHIBITED.

REV.	DESCRIPTION OF CHANGES	
	DATE	BY
1	ECRN 13559	DJD 4/2/03
2	ECRN 13830 - ADD (4) MNTG. HOLES	AMP 5/11/05

NOTES:

1. MATERIAL = #11 GA COLD ROLLED STEEL
2. FINISH = ELECTROSTATIC POWDER COAT EPOXY-CRIMSON
3. USE WITH CAT. NO. 993G1 (BATTERY BRACKET)
4. CONNECTORS SOLD SEPARATELY

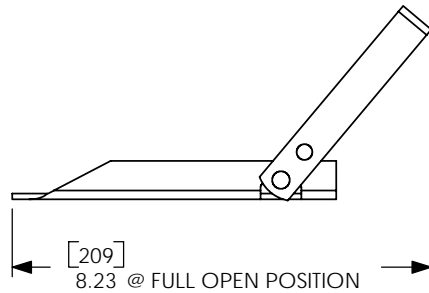
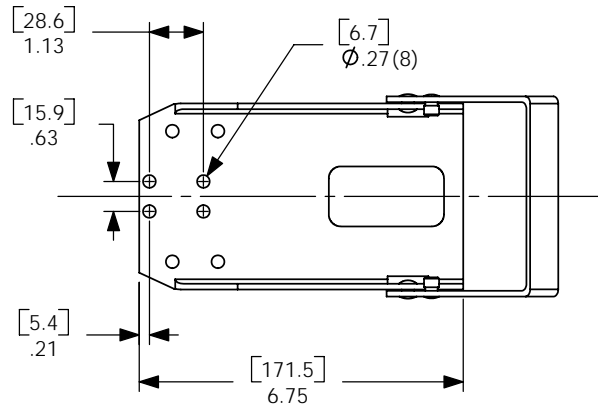

CHARGER/TRUCK BRACKET ASSEMBLY (CAT. NO. 994G1)

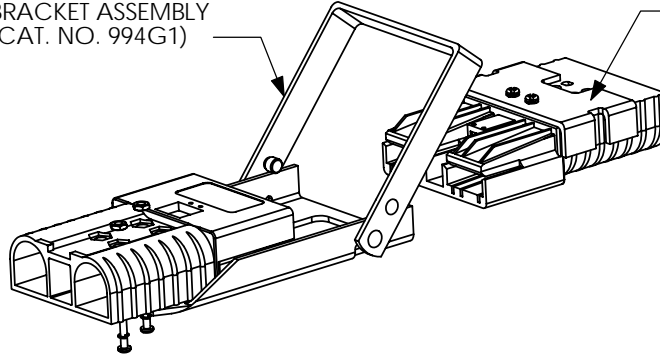

BATTERY BRACKET (CAT. NO. 993G1)

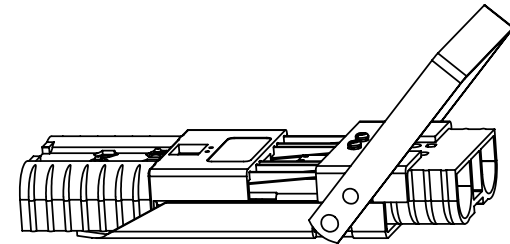

OPEN POSITION

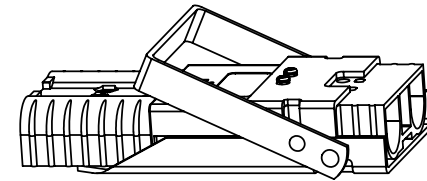
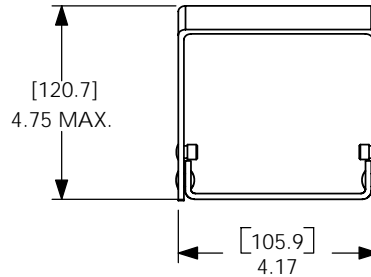

CLOSED POSITION

COMPONENTS FOR SBE320/SBX350
MANUAL RELEASE
CHARGER/TRUCK HALF

COMPONENT	QTY
CHARGER/TRUCK BRACKET ASSY	1
SCREWS	2
WASHERS	2
NUTS	2

ITEM NO.	PART OR IDENTIFYING NO.	NOMENCLATURE OR DESCRIPTION	MATERIAL SPECIFICATION	QTY RECD
COPYRIGHT 1999 ANDERSON POWER PRODUCTS. ALL RIGHTS RESERVED. UNAUTHORIZED REPRODUCTION HEREBY PROHIBITED.				
DIMENSIONS ARE IN INCHES DIMENSIONS IN PARENTHESES [] ARE IN MILLIMETERS		CAD GENERATED DRAWING, DO NOT MANUALLY UPDATE		ANDERSON POWER PRODUCTS
TOLERANCES ARE: 2PL- ±.02 [±.5]		APPROVALS	DATE	
		DRAWN	CMS 4/14/00	CATALOG NUMBER 994G1 SBE320/SBX350 MANUAL RELEASE CHARGER/TRUCK BRACKET
		CHECKED	DJD 4/24/00	
		RESP ENG	UFN 4/25/00	SIZE A SPECIFICATION: 114238S2 REV. 2
		MFG ENG	CHB 4/25/00	
NEXT ASSY	USED ON	QUAL ENG	RPO 5/8/00	SCALE NONE
APPLICATION		DO NOT SCALE DRAWING		CADFILES/01212 SHEET 1 OF 1